



COMHAIRLE CONTAE CHILL Mhantáin
Wicklow County Council

Pleanáil, Forbairt Eacnamaíochta agus Tuaithe
Planning, Economic and Rural Development

Áras An Chontae / County Buildings
Cill Mhantáin / Wicklow
Guthán / Tel (0404) 20148
Faics / Fax (0404) 69462
Rphost / Email plandev@wicklowcoco.ie
Suíomh / Website: www.wicklow.ie

Bébhinn & Colin Byrne

 Of April 2026

RE: Declaration in accordance with Section 5 of the Planning & Development Acts
2000 (As Amended) -EX38/2026

A Chara,

I enclose herewith Declaration in accordance with Article 5 (2) (A) of the Planning &
Development Act 2000.

Where a Declaration is used under this Section any person issued with a Declaration under
subsection (2) (a) may, on payment to An Coimisiún Pleanála of such fee as may be
prescribed, refer a declaration for review by the Coimisiún within four weeks of the date of
the issuing of the declaration by the Local Authority.

Is mise, le meas,

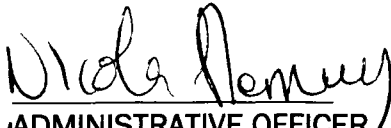
ADMINISTRATIVE OFFICER
PLANNING DEVELOPMENT & ENVIRONMENT.





COMHAIRLE CONTAE CHILL MHANTÁIN Wicklow County Council

**Pleanáil, Forbairt Eacnamaíochta agus Tuaithe
Planning, Economic and Rural Development**

Áras An Chontae / County Buildings
Cill Mhantáin / Wicklow
Guthán / Tel: (0404) 20148
Faics / Fax (0404) 69462
Rphost / Email: plandev@wicklowcoco.ie
Suíomh / Website: www.wicklow.ie

DECLARATION IN ACCORDANCE WITH ARTICLE 5 (2) (A) OF THE PLANNING & DEVELOPMENT ACT 2000 AS AMENDED

Applicant: Bébhinn & Colin Byrne

Location: 12 Templeraíne Park, Arklow, Co. Wicklow

Reference Number: EX 38/2026

CHIEF EXECUTIVE ORDER NO. CE/PERD/2026/452

A question has arisen as to whether “(a) remove porch structure attached to front and replace with new covered entrance, (b) installation of roof lights to front elevation, (c) alterations to front, including removal of timber cladding and installation of insulation and render finish to front elevation and other walls” at 12 Templeraíne Park, Arklow, Co. Wicklow is or is not exempted development.

Having regard to:

- a) The details received with the Section 5 Declaration on the 24/03/2026
- b) Sections 2, 3 and 4 of the Planning & Development Act 2000 (as amended)
- c) An Coimisiún Pleanála Declarations ABP-301692-18 and ABP-309407-21
- d) The character of Templeraíne Park which is dominated by a timber clad section and brown brick fronted houses

Main Reasons with respect to Section 5 Declaration:

- i. The removal of porch, covered entrance, roof lights and placement of insulation are alterations which would come within the meaning of works as set out in Section 2 of the Planning and Development Act 2000(as amended),
- ii. The identified works are development having regard to the provisions of Section 3 of the Planning and Development Act 2000(as amended).
- iii. The removal of the porch and replacement with new covered entrance , and the installation of rooflights are works of maintenance/ improvement, these works would not materially affect the external appearance of the structure so as to render the appearance inconsistent with the character of the structure or of neighbouring structure, and the works would therefore come within the provisions of Section 4 (1)(h) of the Planning and Development Act 2000 (as amended).
- iv. Having regard to the character of Templeraíne Park which is dominated by a timber clad section and brown brick fronted houses, the removal of timber cladding and placement of the insulation on the front façade would totally conceal the existing finish to the dwelling, and therefore would render the structure inconsistent with the character of the structure and of neighbouring structures, and therefore the works would not come within the provisions of Section 4(1)(h) of the Planning and Development Act 2000(as amended)



The Planning Authority considers that:

- (a) The works to “remove porch structure attached to front and replace with new covered entrance” at 12 Templeraíney Park, Arklow, Co. Wicklow is development and **is exempted development.**
- (b) “Installation of roof lights to front elevation” at 12 Templeraíney Park, Arklow, Co. Wicklow, is development and **is exempted development.**
- (c) “Alterations to front, including removal of timber cladding and installation of insulation and render finish to front elevation and other walls” 12 Templeraíney Park, Arklow, Co. Wicklow is development and **is not exempted development.**

Within the meaning of the Planning & Development Act 2000 (as amended)

Signed: Wida Flanagan
ADMINISTRATIVE OFFICER
PLANNING DEVELOPMENT & ENVIRONMENT

Date: 20/04/26

WICKLOW COUNTY COUNCIL

PLANNING & DEVELOPMENT ACTS 2000 (As Amended)
SECTION 5

CHIEF EXECUTIVE ORDER NO. CE/PERD/2026/452

Reference Number: EX 38/2026

Name of Applicant: Bébhinn & Colin Byrne

Nature of Application: Section 5 Referral as to whether “(a) remove porch structure attached to front and replace with new covered entrance, (b) installation of roof lights to front elevation, (c) alterations to front, including removal of timber cladding and installation of insulation and render finish to front elevation and other walls” is or is not development and is or is not exempted development.

Location of Subject Site: 12 Templeraíney Park, Arklow, Co. Wicklow

Report from: Holly O'Connor, EP, Edel Bermingham, T/SP

With respect to the query under Section 5 of the Planning & Development Act 2000 as to whether “(a) remove porch structure attached to front and replace with new covered entrance, (b) installation of roof lights to front elevation, (c) alterations to front, including removal of timber cladding and installation of insulation and render finish to front elevation and other walls” at 12 Templeraíney Park, Arklow, Co. Wicklow is or is not exempted development within the meaning of the Planning & Development Act 2000 (as amended)

Having regard to:

- a) The details received with the Section 5 Declaration on the 24/03/2026
- b) Sections 2, 3 and 4 of the Planning & Development Act 2000 (as amended)
- c) An Coimisiún Pleanála Declarations ABP-301692-18 and ABP-309407-21
- d) The character of Templeraíney Park which is dominated by a timber clad section and brown brick fronted houses

Main Reasons with respect to Section 5 Declaration:

- i. The removal of porch, covered entrance, roof lights and placement of insulation are alterations which would come within the meaning of works as set out in Section 2 of the Planning and Development Act 2000(as amended),
- ii. The identified works are development having regard to the provisions of Section 3 of the Planning and Development Act 2000(as amended).
- iii. The removal of the porch and replacement with new covered entrance , and the installation of rooflights are works of maintenance/ improvement, these works would not materially affect the external appearance of the structure so as to render the appearance inconsistent with the character of the structure or of neighbouring structure, and the works would therefore come within the provisions of Section 4 (1)(h) of the Planning and Development Act 2000 (as amended).
- iv. Having regard to the character of Templeraíney Park which is dominated by a timber clad section and brown brick fronted houses, the removal of timber cladding and placement of the insulation on the front façade would totally conceal the existing finish to the dwelling, and therefore would render the structure inconsistent with the character of the structure and of neighbouring structures, and therefore the works would not come within the provisions of Section 4(1)(h) of the Planning and Development Act 2000(as amended)

Recommendation

The Planning Authority considers that:

- (a) The works to "remove porch structure attached to front and replace with new covered entrance" at 12 Templeraíney Park, Arklow, Co. Wicklow is development and is **exempted development**.
- (b) "Installation of roof lights to front elevation" at 12 Templeraíney Park, Arklow, Co. Wicklow, is development and is **exempted development**.
- (c) "Alterations to front, including removal of timber cladding and installation of insulation and render finish to front elevation and other walls" 12 Templeraíney Park, Arklow, Co. Wicklow is development and is **not exempted development**.

Within the meaning of the Planning & Development Act 2000 (as amended)

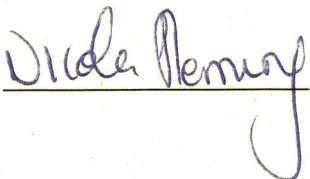
Signed: 

Date: 20/04/2020

ORDER:

I HEREBY DECLARE:

- (a) The works to "remove porch structure attached to front and replace with new covered entrance" at 12 Templeraíney Park, Arklow, Co. Wicklow is development and is **exempted development**.
- (b) "Installation of roof lights to front elevation" at 12 Templeraíney Park, Arklow, Co. Wicklow, is development and is **exempted development**.
- (c) "Alterations to front, including removal of timber cladding and installation of insulation and render finish to front elevation and other walls" 12 Templeraíney Park, Arklow, Co. Wicklow is development and is **not exempted development**.

Signed: 

Date: 20/4/2020

T/Senior Planner
Planning, Economic & Rural Development

**WICKLOW COUNTY COUNCIL
PLANNING DEPARTMENT**

PLANNING REPORT SECTION 5 APPLICATION

TO:	EDEL BERMINGHAM S.P/ PATRICE RYAN S.E.P
FROM:	HOLLY O'CONNOR E.P.
SUBJECT REF:	EX 38/2026
DECISION DATE:	20/04/2026
APPLICANT:	BEIBHINN & COLIN BYRNE
ADDRESS:	12 TEMPLERAINEY PARK, ARKLOW
EXEMPTION QUERY:	REMOVAL OF PORCH AND INSTALLATION OF ROOF LIGHTS TO FRONT

Site Location:

The subject site is located in the housing estate Templeraíney Pk, in the urban area of Arklow Town, on lands zone RE-Existing Residential. The site can be accessed via the L61794-2. The subject site consists of a two storey detached dwelling with a garage to the side. All of the dwellings in the estate are uniform in design.

Planning History:

None on subject site.

Land use:

Settlement:	Arklow & Environs Local Area Plan
Zoning	RE – Existing Residential

Relevant legislation:

Planning and Development Act 2000 (as amended)

Section 2:

“structure” means any building, structure, excavation, or other thing constructed or made on, in or under any land, or any part of a structure so defined, and—

(a) where the context so admits, includes the land on, in or under which the structure is situate, and

“works” includes any act or operation of construction, excavation, demolition, extension, alteration, repair or renewal and, in relation to a protected structure or proposed protected structure, includes any act or operation involving the application or removal of plaster, paint, wallpaper, tiles or other material to or from the surfaces of the interior or exterior of a structure.

Section 3:

(1) In this Act, except where the context otherwise requires, "development" means—

(a) the carrying out of any works in, on, over or under land, or the making of any material change in the use of any land or structures situated on land, or

(b) development within the meaning of Part XXI (inserted by section 171 of the Maritime Area Planning Act 2021).

Section 4:

4.— (1) The following shall be exempted developments for the purposes of this Act—

(h) development consisting of the carrying out of works for the maintenance, improvement or other alteration of any structure, being works which affect only the interior of the structure or which do not materially affect the external appearance of the structure so as to render the appearance inconsistent with the character of the structure or of neighbouring structures;

(3); A reference in this Act to exempted development shall be construed as a reference to development which is—

(a) any of the developments specified in subsection (1), or

(b) development which, having regard to any regulations under subsection (2), is exempted development for the purposes of this Act.

Planning & Development Regulations 2001 (as amended)

Article 6 (1) Subject to article 9, development of a class specified in column 1 of Part 1 of Schedule 2 shall be exempted development for the purposes of the Act, provided that such development complies with the conditions and limitations specified in column 2 of the said Part 1 opposite the mention of that class in the said column 1.

Article 9(1) (a) and (b) details a number of circumstances under which the development to which Article 6 relates shall not be exempted development for the purposes of the Act.

An Coimisiun Pleanála Referrals:

ABP-301692-18

An Bord Pleanála, in exercise of the powers conferred on it by section 5 (3)(a) of the 2000 Act, hereby decides that the installation of external insulation to front, side and back of house at 134 Cabra Road, Dublin is development and is not exempted development.

An Bord Pleanála has concluded that - (a) The character of Cabra Road in the vicinity of the house site is derived principally from the extent of original orange hued redbrick and ornamental features depicted in stone, brick detailing and timber. (b) The works, which amount to – (i) the entire concealment and removal of key original materials, finishes and ornamental features in the façade as viewed from the street, and

(ii) a red tile façade, are visually incongruous with regard to the original and adjoining houses and materially alter the character of house in the context of the streetscape.

The works, therefore, are development and are not exempt because the proposed works would materially affect the external appearance of the structure so as to render the appearance inconsistent with the character of the house and neighbouring properties as defined under section 4 (1)(h) of the Planning and Development Act 2000, as amended:

ABP-309407-21

An Bord Pleanála, in exercise of the powers conferred on it by section 5 (3) (a) of the 2000 Act, hereby decides that the installation of external insulation to the exterior of the dwelling house at number 16 Beech Park Avenue, Foxrock, Dublin is development and is not exempted development as -

(a) the installation of external insulation to the exterior of the dwellinghouse constitutes works which are development, as defined in section 3 of the Planning and Development Act, 2000, as amended,

(b) the installation of external insulation to the exterior of the dwelling house constitutes "works for the maintenance, improvement or other alteration of any structure" as defined in section 4(1)(h) of the said Act,

(c) the installation of external insulation to the exterior of the dwellinghouse constitutes works which amount to the entire concealment of exterior details and finishes which are defining characteristics of the semi-detached housing along Beech Park Avenue and which, therefore, materially affect the external appearance of the structure so as to render the appearance inconsistent with the character of the structure and that of neighbouring structures, and the installation of external insulation to the exterior of the dwellinghouse accordingly does not come within the scope of Section 4(1)(h) of the Planning and Development Act, 2000, as amended

Declaration details submitted:

- Remove porch structure attached to front and replace with new covered entrance,
- Installation of roof lights to front elevation,
- Alterations to front, including removal of timber cladding and installation of insulation and render finish to front elevation and other walls.

Assessment:

The first assessment must be whether or not the proposal outlined above constitutes development within the remit of Section 3 of the Planning and Development Act 2001. In this regard, Section 2 of the Act defines works as "works" alteration of the interior or exterior of a structure. Section 3 of the Planning and Development Act provides that: "development" means, except where the context otherwise requires, the carrying out of any works on, in, over or under land or the making of any material change in the use of any structures or other land. I am satisfied that the proposal would involve works to a structure and therefore the proposal does constitute development.

The second stage of the assessment is to determine whether or not the proposal would be exempted development under the Planning and Development Act 2000 (as amended) or it's associated Regulations.

The removal of the existing porch structure and installation of a new covered door with a zinc finish and the installation of the flat roof windows to the garage structure and lean too, is considered to be development consisting of the carrying out of works for the improvement or the structure, being works which do not materially affect the external appearance of the structure so as to render the appearance inconsistent with the character of the structure or of neighbouring structures; therefore that development is exempt as per S.4(1)(h).

The removal of the timber cladding to the front and new render nap render is considered to be development consisting of the carrying out of works for the improvement or the structure; however, this is works which do materially affect the external appearance of the structure so as to render the appearance inconsistent with the character of the structure or of neighbouring structures, given that

the character of the estate is a uniform finish of a timber cladding section and brown brick façade. There is one dwelling in the estate that has a render finish where there was originally brick, but there is no planning history associated with this façade change and it does not alter the overall character of the estate. Therefore, the new façade development is **not** exempt as per S.4(1)(h).

Photos of existing estate:



Recommendation:

With respect to the query under Section 5 of the Planning and Development Act 2000 (as amended), as to whether:

- (a) Remove porch structure attached to front and replace with new covered entrance,
- (b) Installation of roof lights to front elevation,
- (c) Alterations to front, including removal of timber cladding and installation of insulation and render finish to front elevation and other walls.

at 12 Templeraíney Park, Arklow, Co. Wicklow constitutes exempted development within the meaning of the Planning and Development Acts, 2000(as amended).

The Planning Authority considers that;

- (a) The works to remove porch structure attached to front and replace with new covered entrance **is development and is exempted development.**
- (b) Installation of roof lights to front elevation, **is development and is exempted development.**
- (c) Alterations to front, including removal of timber cladding and installation of insulation and render finish to front elevation and other walls, **is development and is not exempted development.**

Main Considerations with respect to Section 5 Declaration:

- a) The details received with the Section 5 Declaration on the 24/03/2026,
- b) Sections 2, 3 and 4 of the Planning & Development Act 2000 (as amended),
- c) An Coimisiun Pleanála Declarations ABP-301692-18 and ABP-309407-21,
- d) The character of Templeraíney Park which is dominated by a timber clad section and brown brick fronted houses,

Main Reasons with respect to Section 5 Declaration:

- i. The removal of porch, covered entrance, roof lights and placement of insulation are alterations which would come within the meaning of works as set out in Section 2 of the Planning and Development Act 2000(as amended),
- ii. The identified works are development having regard to the provisions of Section 3 of the Planning and Development Act 2000(as amended).
- iii. The removal of the porch and replacement with new covered entrance, and the installation of rooflights are works of maintenance/ improvement, these works would not materially affect the external appearance of the structure so as to render the appearance inconsistent with the character of the structure or of neighbouring structure, and the works would therefore come within the provisions of Section 4 (1)(h) of the Planning and Development Act 2000 (as amended).

- iv. Having regard to the character of Templeraine Park which is dominated by a timber clad section and brown brick fronted houses, the removal of timber cladding and placement of the insulation on the front façade would totally conceal the existing finish to the dwelling, and therefore would render the structure inconsistent with the character of the structure and of neighbouring structures, and therefore the works would not come within the provisions of Section 4(1)(h) of the Planning and Development Act 2000(as amended)

Holly O'Connor

Date 16/04/2026

Holly O'Connor E.P

Holly O'Connor

Agreed 16/4/2026



**Comhairle Contae Chill Mhantáin
Wicklow County Council**

**Pleanáil, Forbairt Eacnamaíochta agus Tuaithe
Planning, Economic and Rural Development**

Áras An Chontae / County Buildings
Cill Mhantáin / Wicklow
Guthán / Tel: (0404) 20148
Faics / Fax: (0404) 69462
Rphost / Email: plandev@wicklowcoco.ie
Suíomh / Website: www.wicklow.ie

MEMORANDUM

WICKLOW COUNTY COUNCIL

**TO: Holly O'Connor
Executive Planner**

**FROM: Nicola Fleming
Staff Officer**

**RE: - EX38/2026 - Declaration in accordance with Section 5 of the
Planning & Development Acts 2000 (as amended)**

I enclose herewith for your attention application for Section 5 Declaration received 24/03/2026.

The due date on this declaration is the 20/04/2026.

**Staff Officer
Planning Development & Environment**



Ta an ádhainne seo seilbh fíorúil ar fáil. Síneadh éiríonnas.
This document is available in a format for people with disabilities.

Ba chóir gach comhfhreagras a sheoladh chuig an Stúirthóir Seirbhísí, Pleanáil, Forbairt Eacnamaíochta agus Tuaithe
All correspondence should be addressed to the Director of Services, Planning, Economic and Rural Development



W I C K L O W



Comhairle Contae Chill Mhantáin
Wicklow County Council

Pleanáil, Forbairt Eacnamaíochta agus Tuaithe
Planning, Economic and Rural Development

Áras An Chontae / County Buildings
Cill Mhantáin / Wicklow
Guthán / Tel: (0404) 20148
Faics / Fax: (0404) 69462
Rphost / Email plandev@wicklowcoco.ie
Suíomh / Website: www.wicklow.ie

Bébhinn & Colin Byrne
87 St. Peters Place
Arklow
Co. Wicklow

25th March 2026

RE: Application for Certificate of Exemption under Section 5 of the Planning and Development Acts 2000 (as amended). – EX38/2026

A Chara

I wish to acknowledge receipt on 24/03/2026 full details supplied by you in respect of the above Section 5 application. A decision is due in respect of this application by 20/04/2026.

Mise, le meas

Nicola Fleming
Staff Officer
Planning, Economic & Rural Development



Tuairiscleanaíocht / Information
Maidir le hEagraireacht / Contact Information

Ba chóir gach comhfhreagras a sheoladh chuig an Stiúrthóir Seirbhísí, Pleanáil, Forbairt Eacnamaíochta agus Tuaithe
All correspondence should be addressed to the Director of Services, Planning, Economic and Rural Development



W I C K L O W

Wicklow County Council
County Buildings
Wicklow
0404-20100

20/03/2026 13:35:24

Receipt No. : L1/314604/360829
***** REPRINT *****

Béibhinn Byrne,
12 Templeraíney Park,
Arklow,
Co. Wicklow
Y14PY88

EXEMPTION CERTIFICATES	80.00
GOODS	80.00
VAT Exempt/Non-vatable	

Total : 80.00 EUR

Tendered :
Credit Card 80.00

Change : 0.00

Issued By : Ruth Graham
From : Customer Service Hub
Vat reg No.0015233H

Bébhinn and Colin Byrne
87 St. Peter's Place,
Arklow,
Co. Wicklow

19th March 2026

Planning Department
Wicklow County Council
County Buildings
Station Road
Wicklow Town
Co. Wicklow
A67 FW96

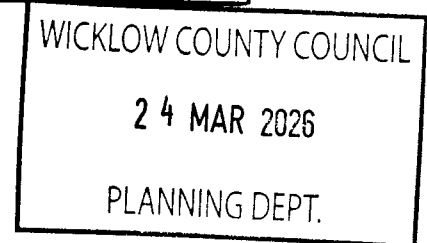
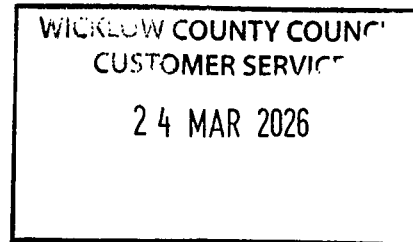

Re: Section 5 Declaration Request -12 Templeraíney Park, Arklow, Co. Wicklow,
Y14PY88

Dear Sir/Madam,

We wish to apply for a declaration under Section 5 of the Planning and Development Act 2000 in respect of works at the above address, and to seek a determination as to whether the proposed works constitute exempted development.

The works in question are as follows:

1. The removal of an existing porch structure attached to the front elevation of the dwelling.
2. The installation of rooflights (skylights) to the roof of an existing single-storey domestic garage within the curtilage of the dwelling. These rooflights are positioned such that they are not visible from the public road and do not give rise to overlooking of neighbouring properties.
3. Alterations to the external finish of the existing dwelling, including the removal of existing timber cladding to the front elevation, the installation of insulation and the application of a render finish to the front elevation and other external walls of the dwelling.

The above works relate to an existing private dwelling house and are confined within the curtilage of the property.

For clarity:

- The porch structure is to be removed.

- The garage is an existing single-storey structure, and the proposed rooflights are limited in scale and serve only the existing use.
- The external works comprise upgrading (there is currently no insulation behind the wooden panelling) and alteration of the existing finishes only.

Enclosed please find the completed Section 5 application form, the appropriate fee, site location map and drawings illustrating the nature and extent of the works.

I would be grateful if Wicklow County Council could issue a declaration as to whether the above works constitute exempted development.

Yours sincerely,

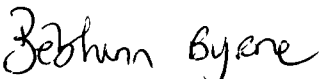
Bébhinn Byrne



Wicklow County Council
County Buildings
Wicklow
Co Wicklow
Telephone 0404 20148
Fax 0404 69462

Office Use Only

Date Received _____

Fee Received _____

**APPLICATION FORM FOR A
DECLARATION IN ACCORDANCE WITH SECTION 5 OF THE PLANNING &
DEVELOPMENT ACTS 2000 (AS AMENDED) AS TO WHAT IS OR IS NOT
DEVELOPMENT OR IS OR IS NOT EXEMPTED DEVELOPMENT**

1. Applicant Details

- (a) Name of applicant: Fébhinn + Colin Byrne
Address of applicant: 87 ST. PETER'S PLACE,
ARKLOW, CO. WICKLOW

Note Phone number and email to be filled in on separate page.

2. Agents Details (Where Applicable)

- (b) Name of Agent (where applicable) _____
Address of Agent : _____

Note Phone number and email to be filled in on separate page.

3. Declaration Details

i. Location of Development subject of Declaration _____
12 TEMPERANCEY PARK, ARKLOW, CO WICKLOW
Y14 PY88

ii. Are you the owner and/or occupier of these lands at the location under i. above ?
 Yes No.

iii. If 'No' to ii above, please supply the Name and Address of the Owner, and or occupier _____

iv. Section 5 of the Planning and Development Act provides that : If any question arises as to what, in any particular case, is or is not development and is or is not exempted development, within the meaning of this act, any person may, on payment of the prescribed fee, request in writing from the relevant planning authority a declaration on that question. You should therefore set out the query for which you seek the Section 5 Declaration REMOVAL OF EXISTING PORCH WALLS TO FRONT ENTRANCE, INSTALLATION OF ROOF WINDOWS AND NAP RENDER FINISH APPLICATION TO EXTERNAL ENVELOPE AS SHOWN ON DRAWINGS

Additional details may be submitted by way of separate submission.

v. Indication of the Sections of the Planning and Development Act or Planning Regulations you consider relevant to the Declaration _____

Additional details may be submitted by way of separate submission.

vi. Does the Declaration relate to a Protected Structure or is it within the curtilage of a Protected Structure (or proposed protected structure) ? NO

vii. List of Plans, Drawings submitted with this Declaration Application _____

SS00 - LOCATION MAP
SS01 - EXISTING PLAN, EXISTING ELEVATIONS, PROPOSED FRONT ELEVATION

viii. Fee of € 80 Attached ? YES

Signed : Reidhun Byrne Dated : 19/3/26
Colin Byrne 19-3-26.

Additional Notes :

As a guide the minimum information requirements for the most common types of referrals under Section 5 are listed below :

A. Extension to dwelling - Class 1 Part 1 of Schedule 2

- Site Location Map
- Floor area of structure in question - whether proposed or existing.
- Floor area of all relevant structures e.g. previous extensions.
- Floor plans and elevations of relevant structures.
- Site Layout Plan showing distance to boundaries, rear garden area, adjoining dwellings/structures etc.

B. Land Reclamation -

The provisions of Article 8 of the Planning and Development Regulations 2001 (as amended) now applies to land reclamation, other than works to wetlands which are still

governed by Schedule 2, Part 3, Class 11. Note in addition to confirmation of exemption status under the Planning and Development Act 2000(as amended) there is a certification process with respect to land reclamation works as set out under the European Communities (Environmental Impact Assessment) (Agriculture) Regulations 2011 S.I. 456 of 2011. You should therefore seek advice from the Department of Agriculture, Fisheries and Food.

Any Section 5 Declaration should include a location map delineating the location of and exact area of lands to be reclaimed, and an indication of the character of the land.

C. Farm Structures - Class 6 -Class 10 Part 3 of Schedule 2.

- Site layout plan showing location of structure and any adjoining farm structures and any dwellings within 100m of the farm structure.
- Gross floor area of the farm structure
- Floor plan and elevational details of Farm Structure and Full details of the gross floor area of the proposed structure.
- Details of gross floor area of structures of similar type within the same farmyard complex or within 100metres of that complex.



SECTION 05 - EXISTING LAYOUT

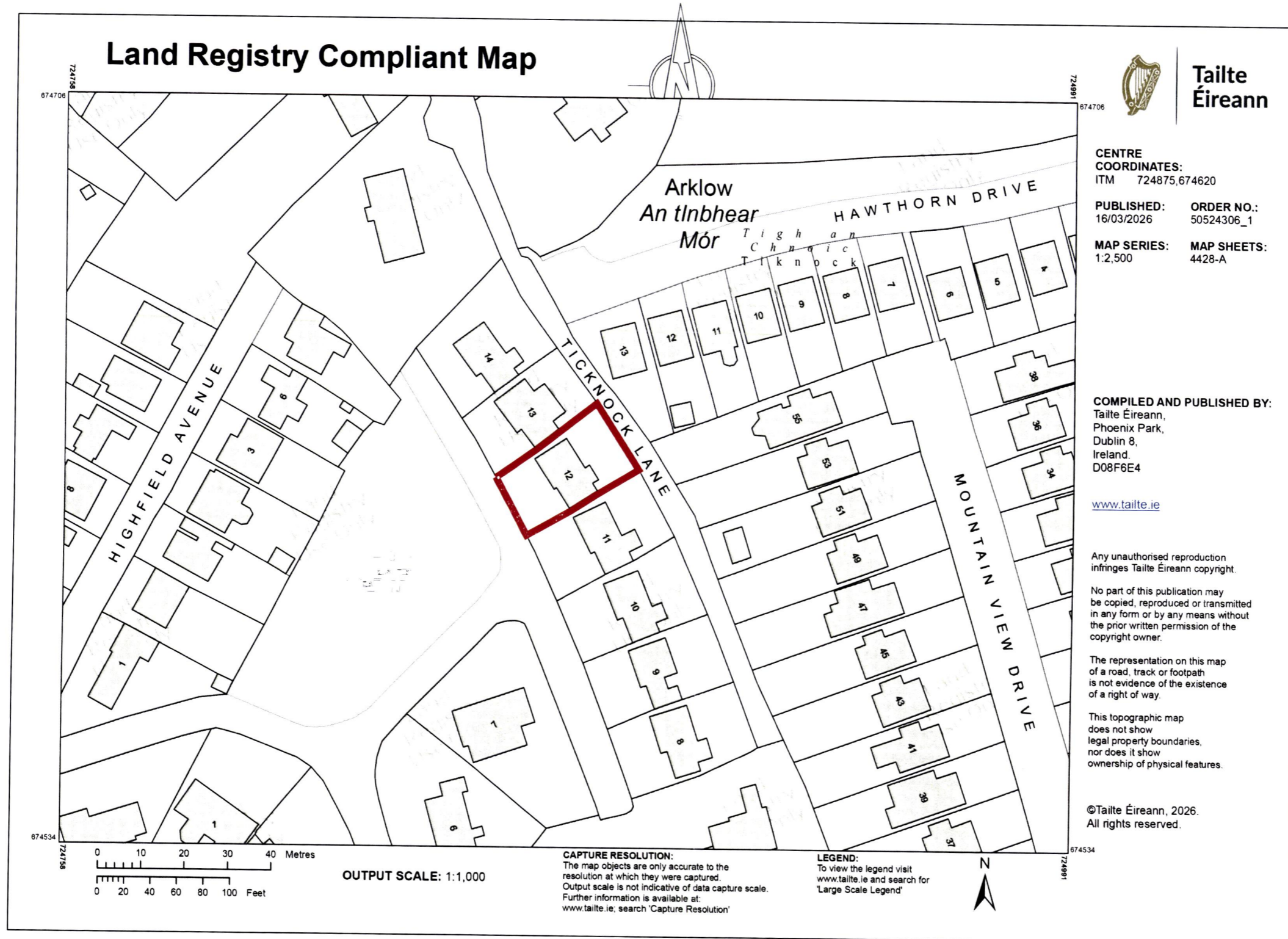

Land Registry Compliant Map



CENTRE COORDINATES:
ITM 724875,674620

PUBLISHED: 16/03/2026
ORDER NO.: 50524306_1

MAP SERIES: 1:2,500
MAP SHEETS: 4428-A

COMPILED AND PUBLISHED BY:
Tailte Éireann,
Phoenix Park,
Dublin 8,
Ireland.
D08F6E4

www.tailte.ie

Any unauthorised reproduction infringes Tailte Éireann copyright.

No part of this publication may be copied, reproduced or transmitted in any form or by any means without the prior written permission of the copyright owner.

The representation on this map of a road, track or footpath is not evidence of the existence of a right of way.

This topographic map does not show legal property boundaries, nor does it show ownership of physical features.

©Tailte Éireann, 2026.
All rights reserved.

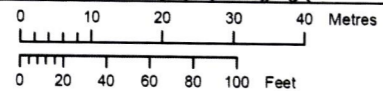

OUTPUT SCALE: 1:1,000

CAPTURE RESOLUTION:
The map objects are only accurate to the resolution at which they were captured. Output scale is not indicative of data capture scale. Further information is available at: www.tailte.ie; search 'Capture Resolution'

LEGEND:
To view the legend visit www.tailte.ie and search for 'Large Scale Legend'





Revision:	Date:	Description:	Checked:
Client:			
BÉBHINN AND COLIN BYRNE			
Property:			
12 TEMPLERAINEY PARK			
Title:			
SECTION 05 SITE LOCATION MAP			
Job No:	Drawn by:	Scale:	
	KF	A3@1:1000	
Drawing No:	Revision:	Checked by:	Date:
S500			16.03.26

****PLEASE NOTE: ALL DIMENSIONS ARE INDICATIVE ONLY AND MUST BE CONFIRMED ON SITE PRIOR TO WORKS COMMENCING****

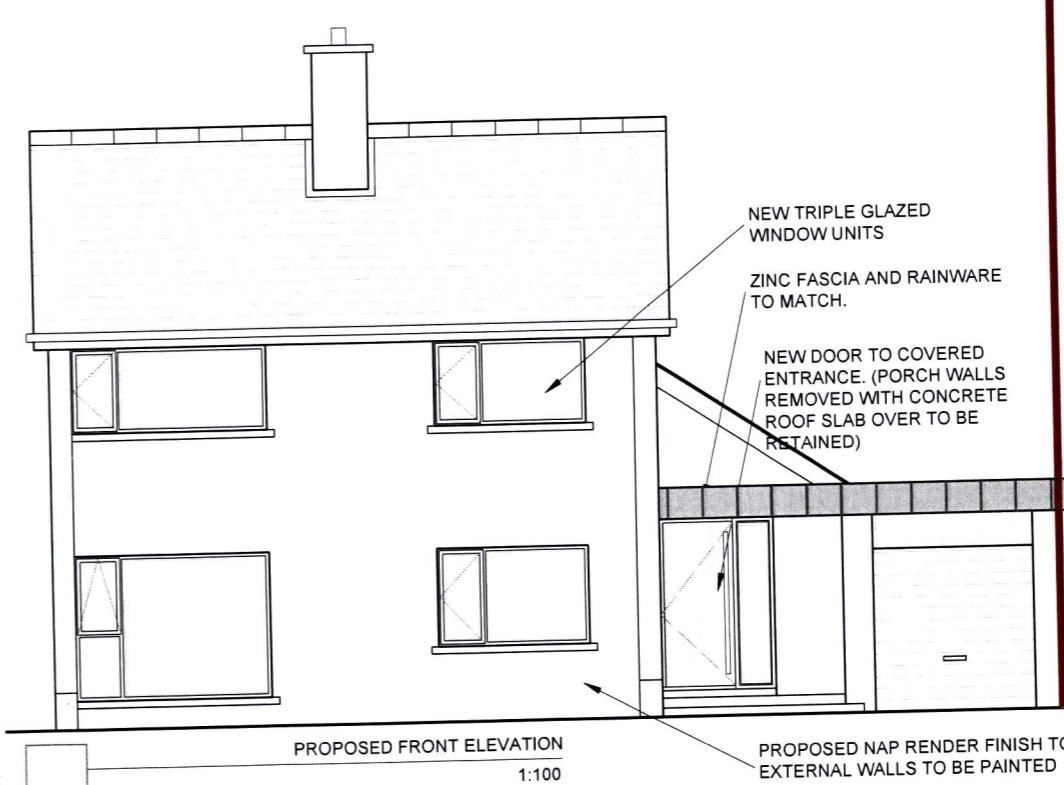
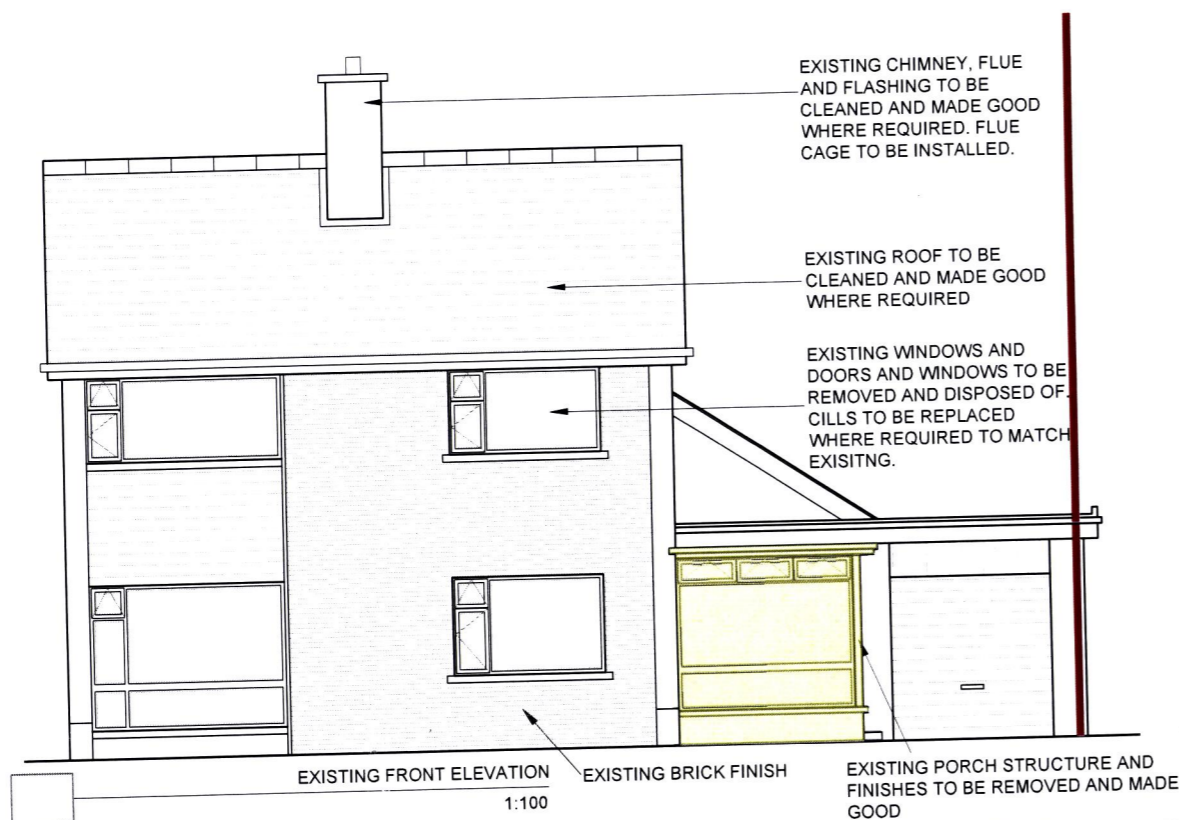
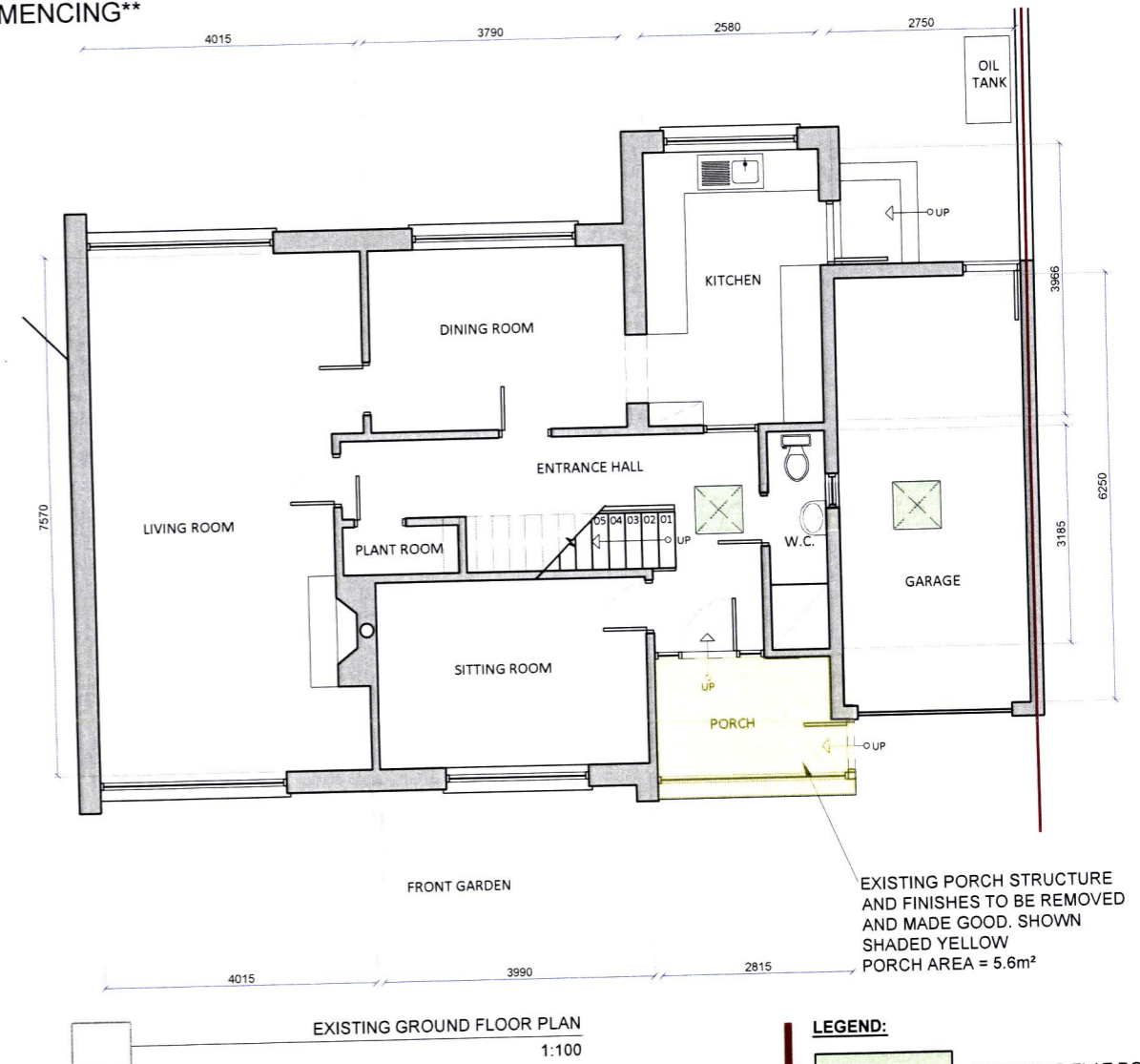
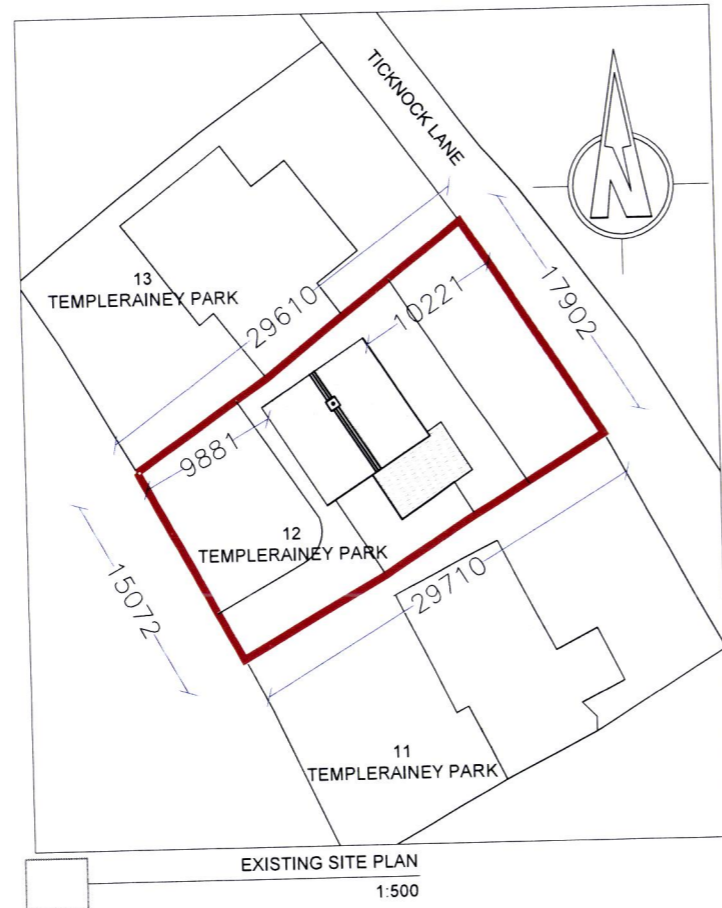
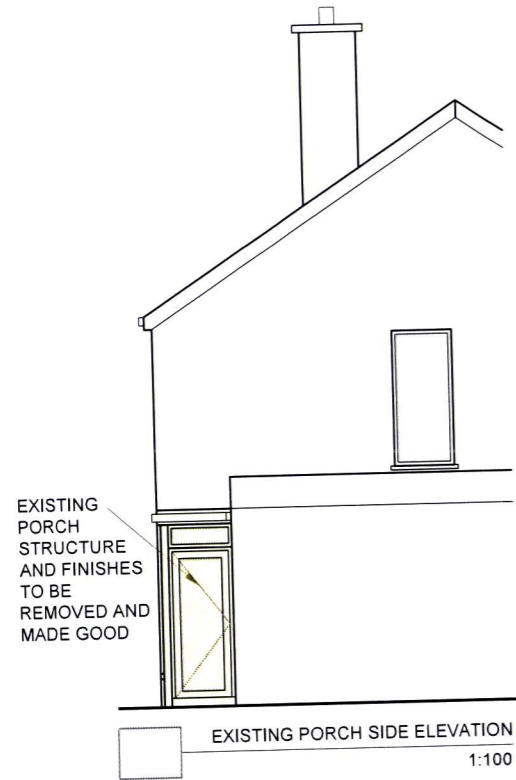
SECTION 05 - EXISTING LAYOUT



LEGEND:

-  PROPOSED FLAT ROOF WINDOW LOCATIONS
-  EXISTING PORCH STRUCTURE AND FINISHES TO BE REMOVED AND MADE GOOD. SHOWN SHADED YELLOW

Revision:	Date:	Description:	Checked:
Client: BÉBHINN AND COLIN BYRNE			
Property: 12 TEMPLERAÍNEY PARK			
Title: SECTION 05 EXISTING LAYOUT ELEVATIONS			
Job No:	Drawn by: KF	Scale: A3@1:100	
Drawing No: S501	Revision:	Checked by:	Date: 16.03.26